

# SIGNATURE

## NORTH EAST

OFFICIALLY RATED THE NO.1 ESTATE AGENT IN THE NORTH EAST





📍 Lazonby Way, Newcastle Upon Tyne NE5 4EN

# Lazonby Way, Newcastle Upon Tyne NE5 4EN

**Asking Price  
£200,000**

Signature North East welcomes you to this modern three-bedroom semi-detached home, ideally located in Westerhope and built in 2019. The property is well positioned for a fantastic range of convenient amenities, including local shops, schools and popular eateries close by. The A1 is within easy reach, providing excellent transport links for commuting across the region.

Step through the entrance hallway into the spacious living room, where elegant French doors lead directly out to the rear garden, creating a bright and inviting space for everyday living. The kitchen/diner offers attractive wall and base units, sleek worktops and an integrated oven, providing a stylish and practical area for cooking and family meals.

Continuing to the first floor, you will find three well-proportioned bedrooms, two of which are generous doubles. The principal bedroom benefits from fitted wardrobes and a convenient en suite, while the family bathroom completes the home and is fitted with a bathtub, overhead shower, wash basin and WC.

Externally, the property enjoys a rear garden laid with lawn and patio, ideal for outdoor dining and relaxation. Off-street parking is available via a double driveway to the rear of the property, adding further convenience to this attractive home.



PLEASE NOTE THAT THE VENDOR HAS CERTIFIED THE PROPERTY INFORMATION AND IMAGES.

# PROPERTY FLOORPLAN

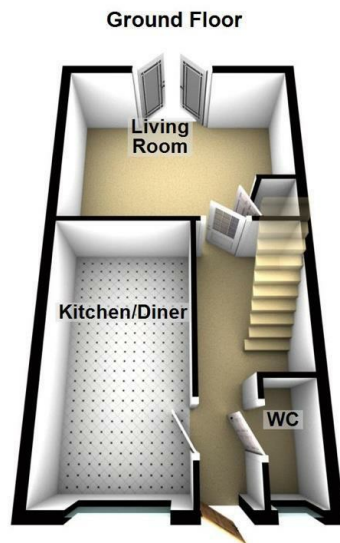

Total area: approx. 76.7 sq. metres (825.9 sq. feet)

## Measurements:

Living Room  
11'3" x 15'0"

Kitchen / Diner  
15'1" x 8'3"

WC  
2'11" x 6'9"

Bedroom One  
8'5" x 11'4"

En Suite  
3'4" x 8'2"

Bathroom  
8'1" x 5'10"

Bedroom Two  
10'4" x 8'3"

Bedroom Three  
9'4" x 6'8"

## Energy Efficiency Rating

	Current	Potential
Very energy efficient - lower running costs		
(92 plus) <b>A</b>		<b>96</b>
(81-91) <b>B</b>	<b>84</b>	
(69-80) <b>C</b>		
(55-68) <b>D</b>		
(39-54) <b>E</b>		
(21-38) <b>F</b>		
(1-20) <b>G</b>		
Not energy efficient - higher running costs		
England & Wales EU Directive 2002/91/EC		





More 5 Star Customer Reviews than any other Agent based in the North East on [allAgents.co.uk](https://allagents.co.uk)



**SALES**

**LETTINGS**

**FINANCE**

**LAW**

**WE COVER THE WHOLE OF THE NORTH EAST**

Whitley Bay  
0191 251 3344

Cramlington  
01670 897 213

Tynemouth  
0191 296 6689

Morpeth  
01670 513 966

Ponteland  
01661 820 082

Wallsend  
0191 432 4151

Alnwick  
01665 511 800

Heaton  
0191 432 4275

Forest Hall  
0191 266 9966

Other locations  
0191 640 3523

Newcastle  
0191 640 2284

Durham  
0191 303 8252

Gosforth  
0191 640 3523

Sunderland  
0191 543 6390

Whickham  
0191 432 5102

Gateshead  
0191 432 4294

Jesmond  
0191 281 1037

Killingworth  
0191 640 3602

Ryton  
0191 413 9845

Head Office &  
Lettings  
0191 253 4815

\*Highest recommended 5-star reviews than any other Estate Agent based in the North East on [allAgents.co.uk](https://allagents.co.uk) - The UK's Largest Customer Review Website for the Property Industry & Awarded Best Estate Agency 2018 & 2019 - North East England by SME News